



## HOPPER

Hopper clearly bears resemblance to the traditional picnic tables everybody knows, but as is typical of Extremis it offers extra comfort. The four pass through zones make it easy to get in and out of Hopper without having to lift your leg over the bench or disturbing your table-companions. Its slanted legs and tabletop edges are a clear reference to the hop poles that are so characteristic of the Westhoek region. If you turn around, you can use the tabletop as a comfortable back rest.



### HOPPER SUMMER BBQ

Hopper is yet another casebook example of the Extremis philosophy: gathering people round a piece of outdoor furniture which unites functionality and innovation.

*See for yourself*

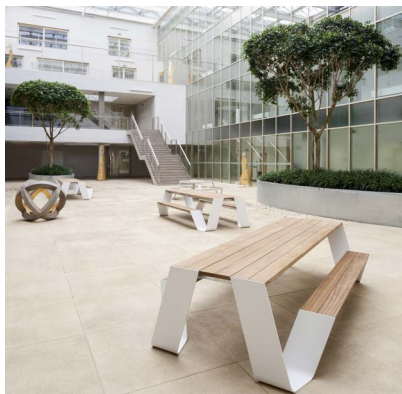

### UZ GASTHUISBERG, LEUVEN, BE

Gasthuisberg's winter garden features Hopper tables and Pantagruel, a nice combo.

*See for yourself*

## CHECK ALL THE DETAILS

Hopper is available in four sizes, a table for ten, eight, six or four people. Choose between a variety of materials, for example galvanised steel legs for extreme durability, or powder coated steel legs for a more refined look.



*Discover more of this collection*

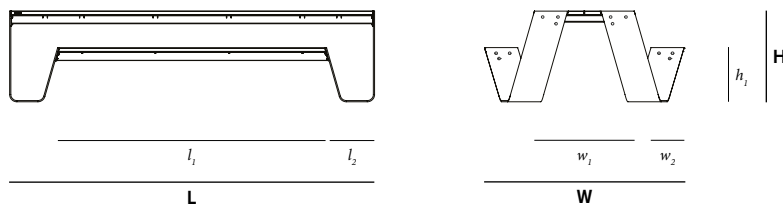

Dimensions (mm)	L	W	H	$l_1$	$l_2$	$w_1$	$w_2$	$h_1$
Hopper 180	1780	1628	740	995	382	832	278	440
Hopper 240	2380	1628	740	1595	382	832	278	440
Hopper 300	2980	1628	740	2195	382	832	278	440
Hopper 360	3580	1628	740	2795	382	832	278	440

## WITH OPTIONAL BACKRESTS

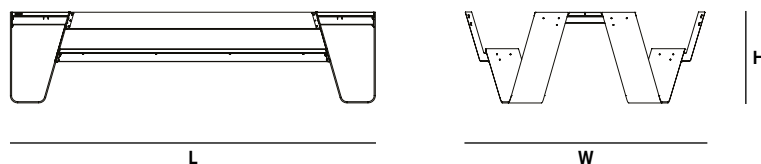

Dimensions (mm)	L	W	H
Back rest 180	819	1946	740
Back rest 240	1419	1946	740
Back rest 300	2019	1946	740
Back rest 360	2619	1946	740

## TOP VIEW

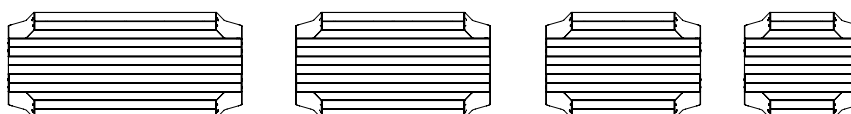

*Download technical sheet – 3d drawings – 2d drawings – skp*

# MOODS

